

ANDREWS PRIMARY BUILDING

LINDSEY MADISON GUDGER
AIA
ARCHITECT

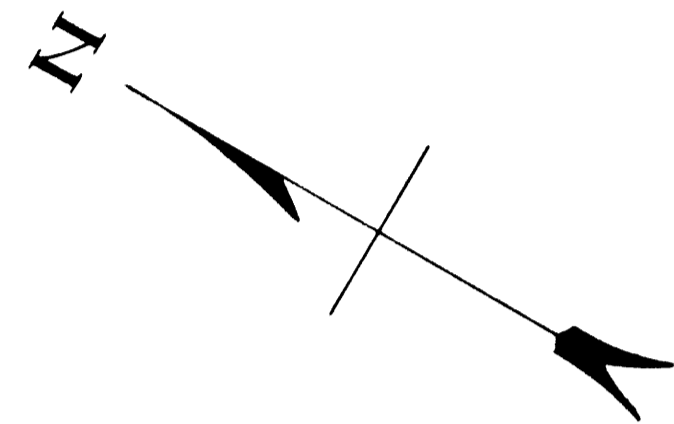

220'
NOT TO SCALE

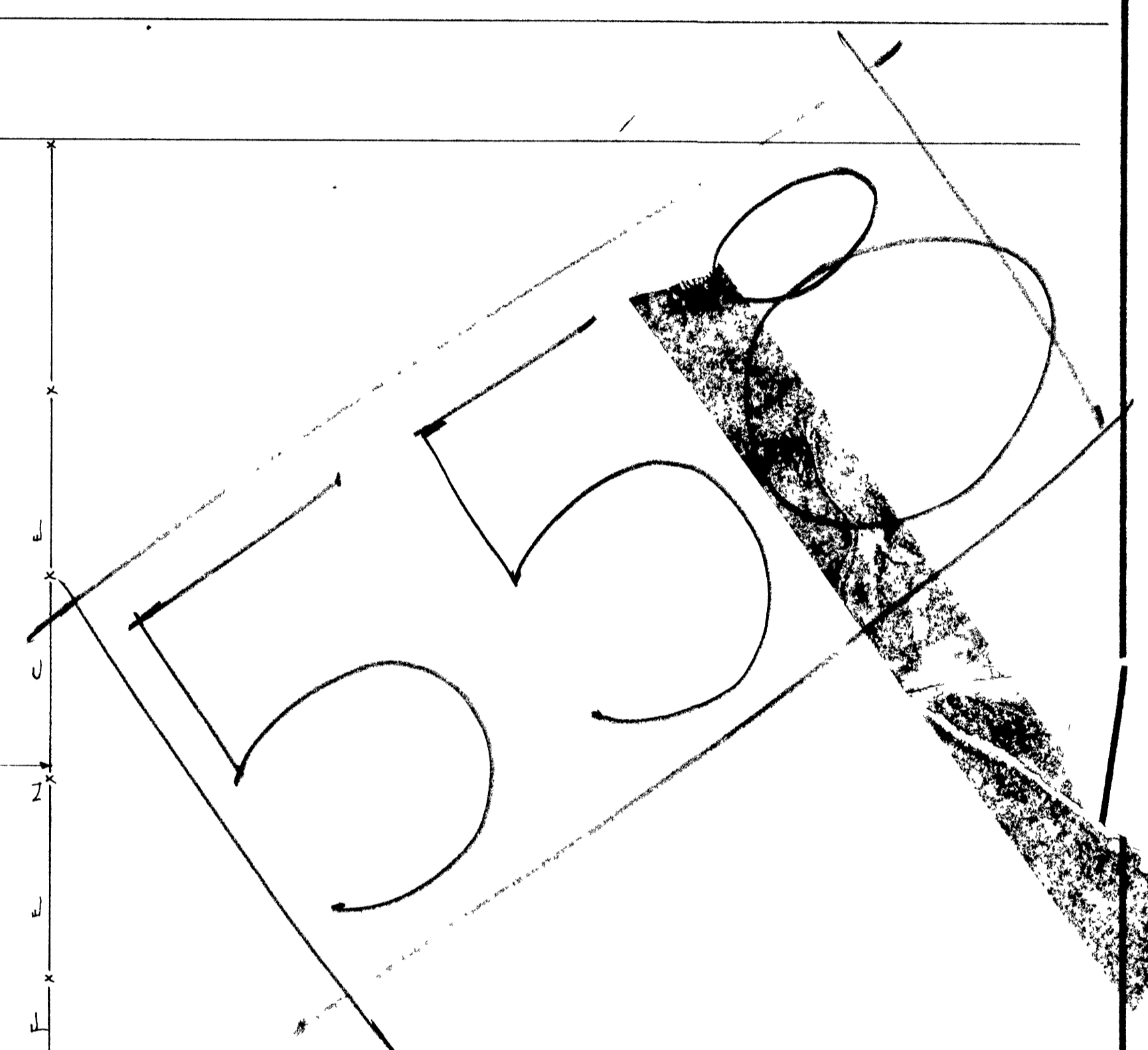
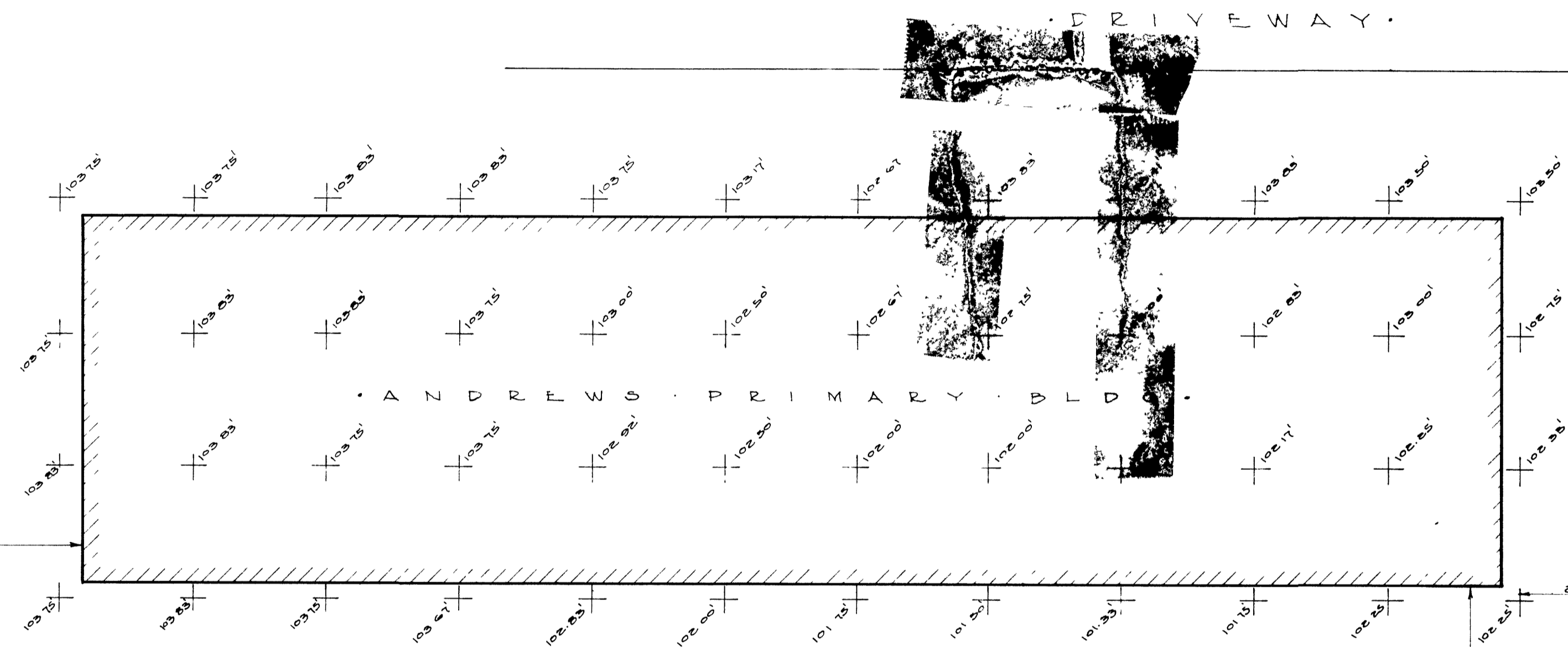

W A L N U T S T R E E T

Approved
6/13/51
L.A.

APPROVED
Olyd H. Ewin
State Superintendent Public Instruction
BY: *John L. Cannon*
Director Schoolhouse Planning

: P L O T P L A N :
S C A L L E : 1/8" = 1'-0"

200 1419

SHEET NO:- 1
DATE: MAY 12, 1951
ACC. NO: 4540