

PLAN A  
SCALE: 1/8" = 1'-0"



PLUMBING PLAN  
SCALE: 1/8" = 1'-0"



PLUMBING PLAN  
SCALE: 1/8" = 1'-0"

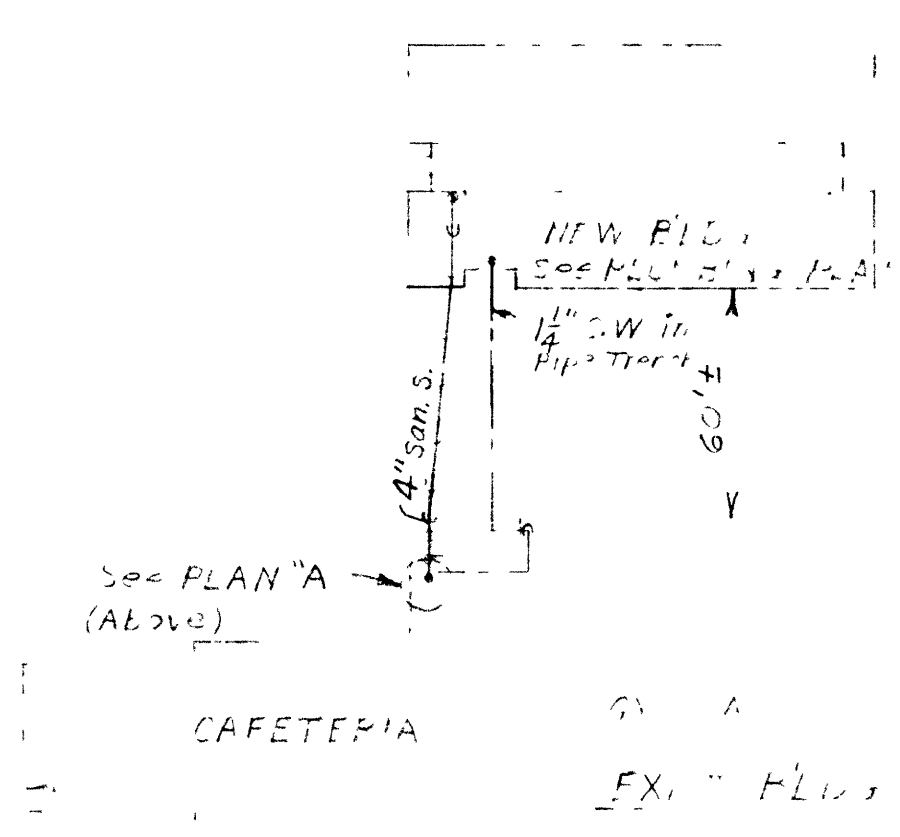

PLOT PLAN  
SCALE: 1" = 50'-0"

SYMBOL	DESCRIPTION
1	1/2" W.P. Pipe
2	1/2" V.P. Pipe
3	1/2" V.P. Tee
4	1/2" V.P. Elbow
5	1/2" V.P. Cap
6	1/2" V.P. Plug
7	1/2" V.P. Coupling
8	1/2" V.P. Union
9	1/2" V.P. Tee
10	1/2" V.P. Tee
11	1/2" V.P. Tee
12	1/2" V.P. Tee
13	1/2" V.P. Tee
14	1/2" V.P. Tee
15	1/2" V.P. Tee
16	1/2" V.P. Tee
17	1/2" V.P. Tee
18	1/2" V.P. Tee
19	1/2" V.P. Tee
20	1/2" V.P. Tee
21	1/2" V.P. Tee
22	1/2" V.P. Tee
23	1/2" V.P. Tee
24	1/2" V.P. Tee
25	1/2" V.P. Tee
26	1/2" V.P. Tee
27	1/2" V.P. Tee
28	1/2" V.P. Tee
29	1/2" V.P. Tee
30	1/2" V.P. Tee
31	1/2" V.P. Tee
32	1/2" V.P. Tee
33	1/2" V.P. Tee
34	1/2" V.P. Tee
35	1/2" V.P. Tee
36	1/2" V.P. Tee
37	1/2" V.P. Tee
38	1/2" V.P. Tee
39	1/2" V.P. Tee
40	1/2" V.P. Tee
41	1/2" V.P. Tee
42	1/2" V.P. Tee
43	1/2" V.P. Tee
44	1/2" V.P. Tee
45	1/2" V.P. Tee
46	1/2" V.P. Tee
47	1/2" V.P. Tee
48	1/2" V.P. Tee
49	1/2" V.P. Tee
50	1/2" V.P. Tee

REGIS & CUMMINGS  
ENGINEERS  
ASHEVILLE, NORTH CAROLINA

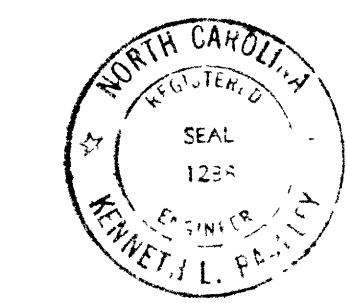

RECEIVED  
JUN 24 1968

200 1420 DIVISION OF SCHOOL PLANNING

A CLASSROOM ADDITION TO	
<b>ANDREWS HIGH SCHOOL</b>	
ANDREWS, NORTH CAROLINA	
DRAWN BY	PLUMBING
DATE	6-11-68
JAMES L. PADGETT, AIA, ARCHITECT	
SUITE 405 NORTHWESTERN BANK BUILDING	
ASHEVILLE, NORTH CAROLINA 28807	
SHEET NO.	P-1
OF 1	