

Sheet number
E-10
0123

RECEIVED
C.W.C.
DRAWN
L/11/75
DATE

EDUCATIONAL UNIT
for the Onslow County
Board of Education
Onslow County, N.C.

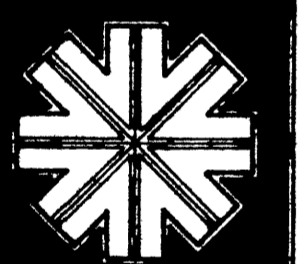

ERIC TOWNSON, A.I.A.
architect - Murphy, N.C.



REECE, NOLAND & MCELRAITH
CONSULTING ENGINEERS
P.O. BOX 540/MAYNESVILLE, NORTH CAROLINA 28786
MAYNESVILLE 7041 456 9851
ASHEVILLE 7041 253 3280

ANDREWS JR. HIGH
DIVISION OF
SCHOOL PLANNING
JUL 30 1975
200 1420

1/8" = 0'
LIGHTING FLOOR PLAN

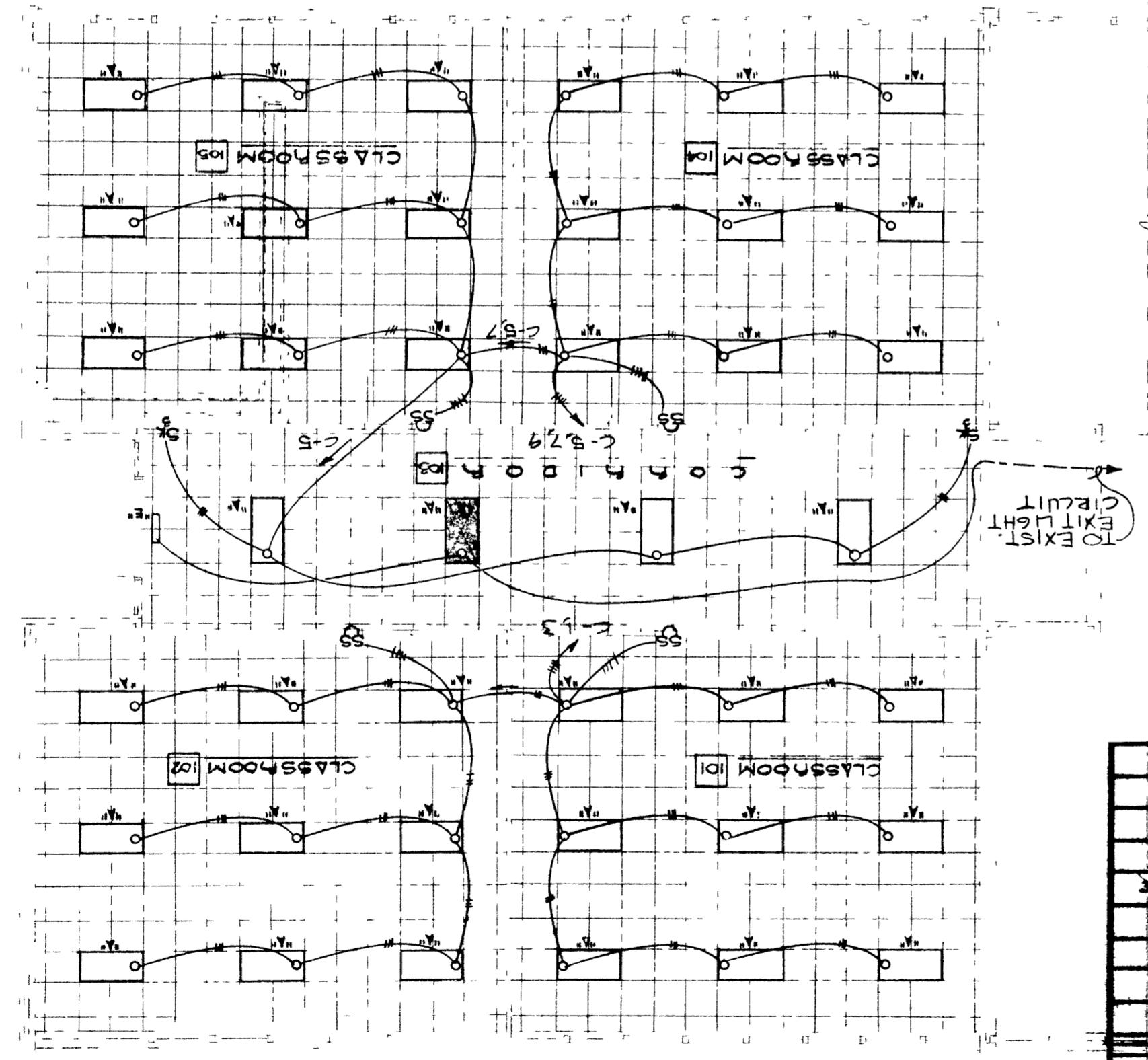

NOTE: CLASSROOM LIGHTS TO BE SWITCHED FOR HALF OR FULL ILLUMINATION

3730
 57
 53
 52
 51
 50
 49
 48
 47
 46
 45
 44
 43
 42
 41
 40
 39
 38
 37
 36
 35
 34
 33
 32
 31
 30
 29
 28
 27
 26
 25
 24
 23
 22
 21
 20
 19
 18
 17
 16
 15
 14
 13
 12
 11
 10
 9
 8
 7
 6
 5
 4
 3
 2
 1
 0

DESCRIPTION/Remarks: Square ft. NOB-18-LT. 120/208, 3%, 4 wire 100 amp M.D.L. flush mounted
Wires: 4- #12 Or.
Conduit: 1 1/2" C

DESCRIPTION	Cond.	Wire	Load	Breaker	Panel	Panel	Panel
101 C.R. 101	3 #12	720W	3 #12	1P-20	2	101	101
102 C.R. 102	3 #12	720W	3 #12	1P-20	4	102	102
103 C.R. 103	3 #12	720W	3 #12	1P-20	6	103	103
104 C.R. 104	1/2	720W	1/2	1P-20	7	104	104
105 C.R. 105	1/2	720W	1/2	1P-20	8	105	105
7 #12 1/2"	1P-20	1500W	1/2"	1P-20	9	105	105
SPACE ONLY					10		
11 C 12	1P-20				11		
14 A 14	1P-20				14		
15 B 16	1P-20				15		
18 C 18	1P-20				18		

Panel # C " SCHEDULE
Connected Load: 10.2 KW
Wires: 4- #12 Or.
Conduit: 1 1/2" C

DESCRIPTION/Remarks: Square ft. NOB-18-LT. 120/208, 3%, 4 wire 100 amp M.D.L. flush mounted
Wires: 4- #12 Or.
Conduit: 1 1/2" C