

1 PARTIAL FLOOR PLAN 'A'
 P-2 1/8"=1'-0" FFE = 1865'

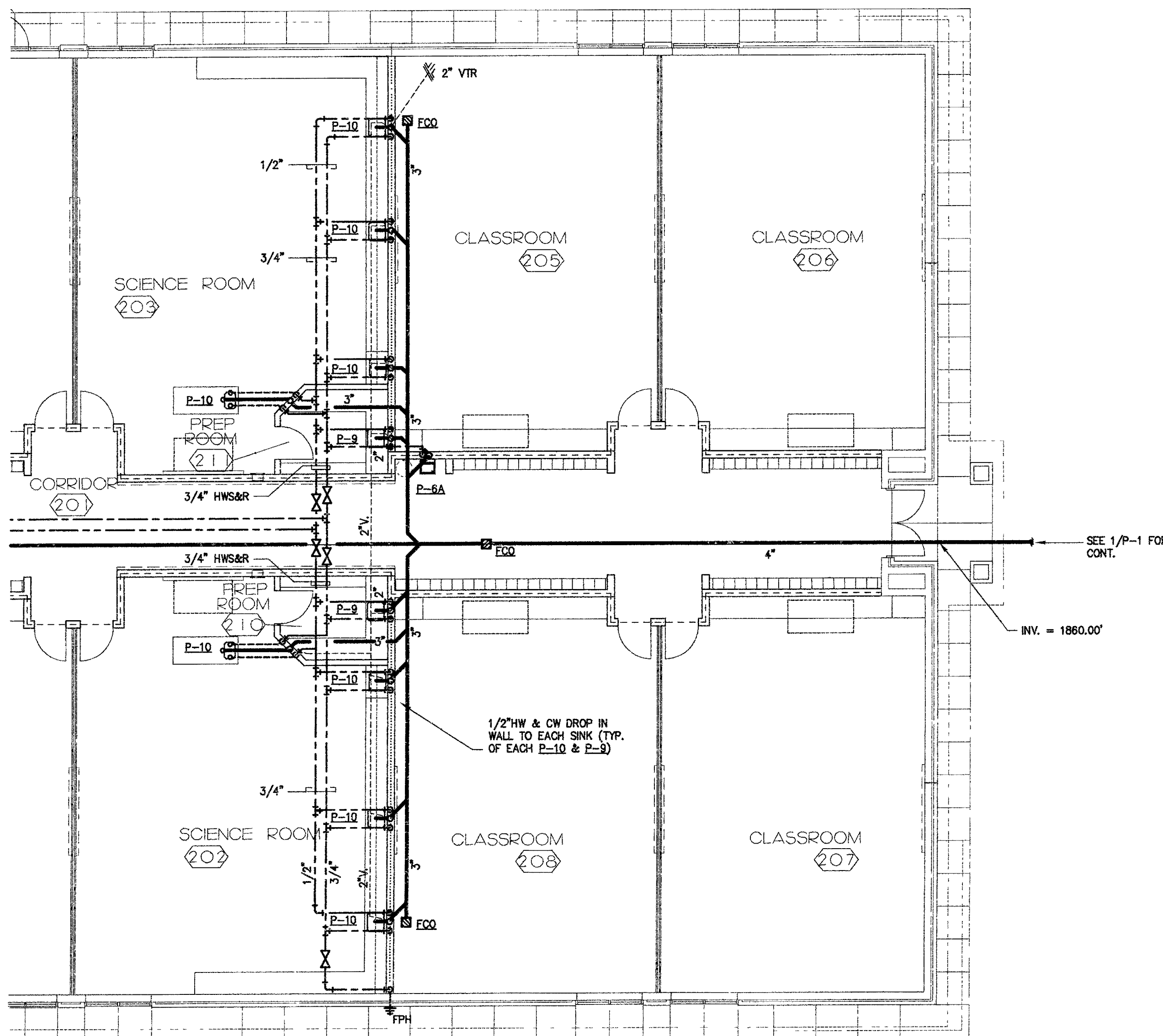

2 PARTIAL FLOOR PLAN 'A'
 P-2 1/8"=1'-0"

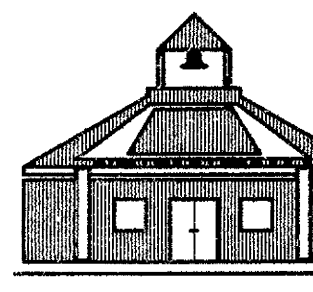
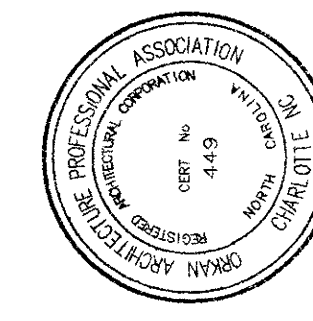
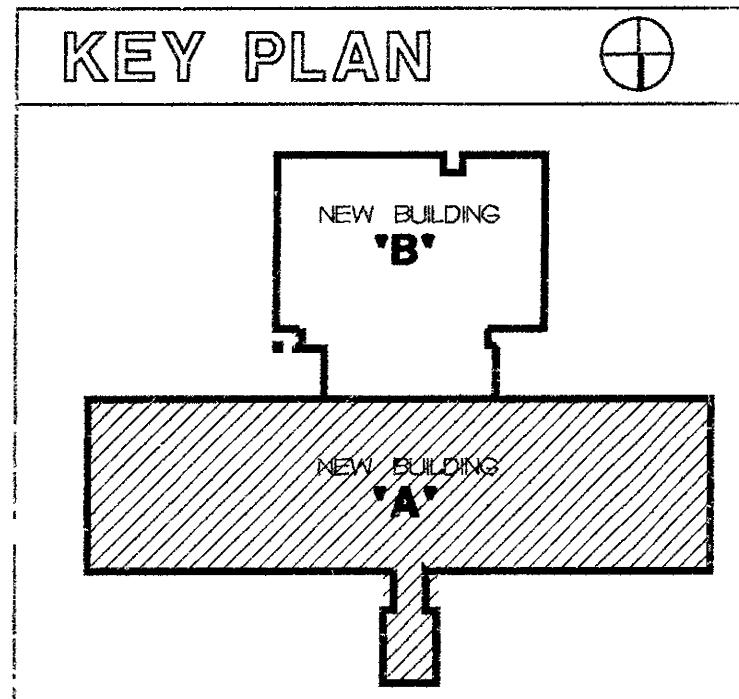

DRAWN BY	APPROVED
CDT	LMW
JOB NO.	AMS-971C
APPROVAL DATE	4/21/9
BID ISSUE DATE	4/28/9
REVISIONS	