

1
COMPOSITE FLOOR PLAN
SCALE: 1/8" = 1'-0"

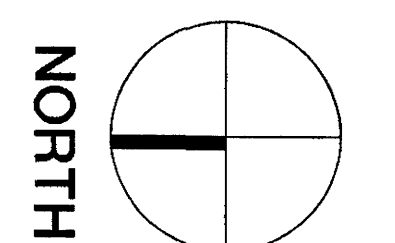
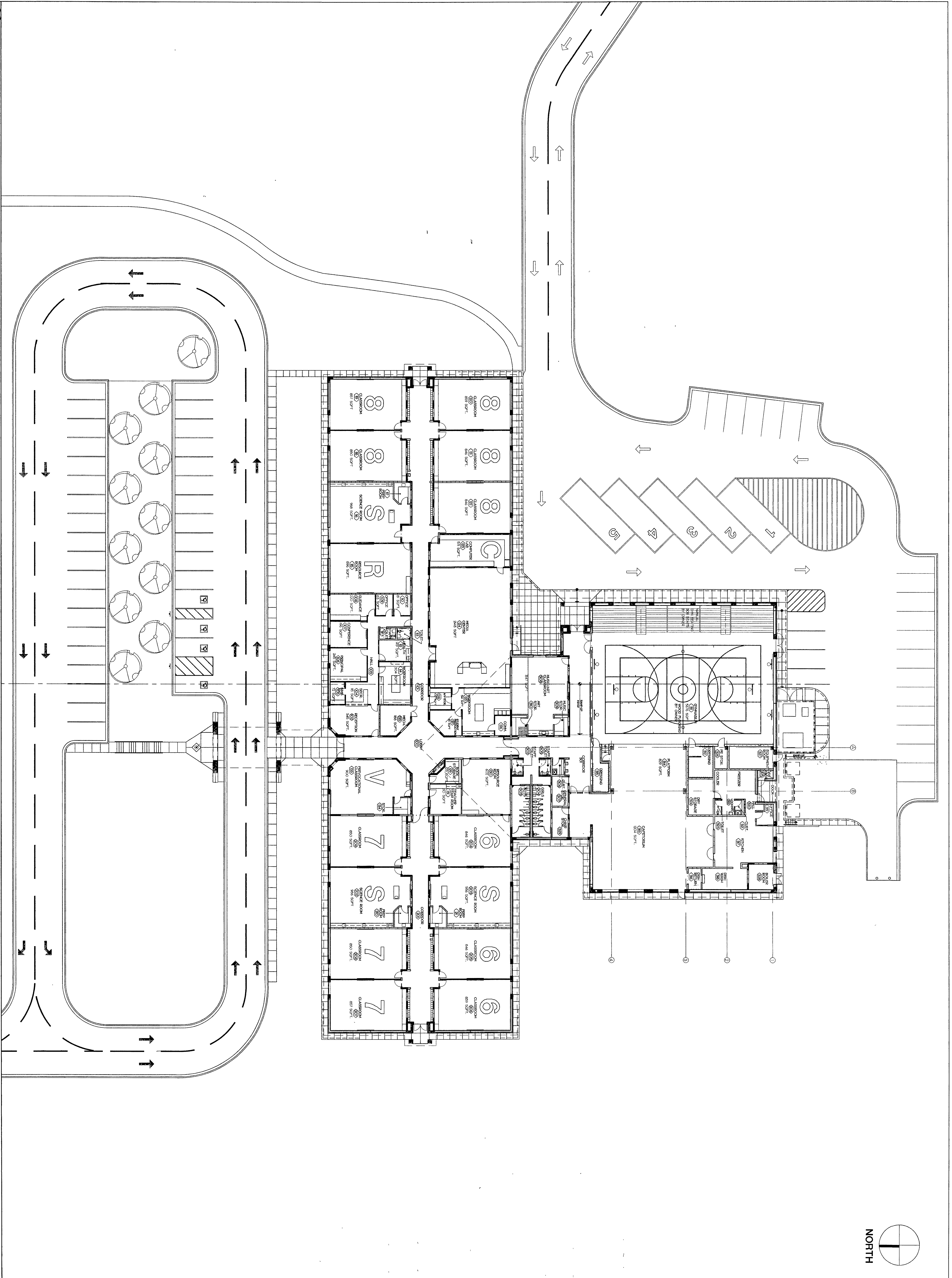

CHEROKEE COUNTY SCHOOLS

COMPOSITE FLOOR PLAN

DESIGNED BY: A.O.
 DRAWN BY: V.B.G.
 JOB NO.: AMS-9703
 APPROVAL DATE: APR 2, 98
 BID DATE: APR 28, 98

REVISIONS:

DATE: 4/1/98

SHEET **A-2** OF 28

DATE: 4/1/98

ANDREWS

MIDDLE SCHOOL
 CHEROKEE COUNTY, N.C.

ORKAN ARCHITECTURE, P.A. HEREBY RESERVES ITS COMMON LAW COPYRIGHT AND OTHER PROPERTY RIGHTS IN THESE DRAWINGS, IDEAS AND DESIGN. THESE DRAWINGS, IDEAS AND DESIGN ARE NOT TO BE REPRODUCED, CHANGED OR COPIED IN ANY FORM OR MANNER WHATSOEVER, AND ARE TO BE ASSIGNED TO ANY THIRD PARTY WITHOUT FIRST OBTAINING THE EXPRESS WRITTEN PERMISSION FROM ORKAN ARCHITECTURE, P.A. WRITTEN PERMISSION ON THESE DRAWINGS SHALL HAVE PRECEDENCE OVER ANY ORAL PERMISSION. CONTRACTORS SHALL VERIFY AND BE RESPONSIBLE FOR ALL DIMENSIONS AND CONDITIONS ON THE JOB AND ORKAN ARCHITECTURE, P.A. SHALL BE NOTIFIED IN WRITING OF ANY VARIATIONS FROM THE DRAWINGS, CONDITIONS AND SPECIFICATIONS SHOWN BY THESE DRAWINGS.

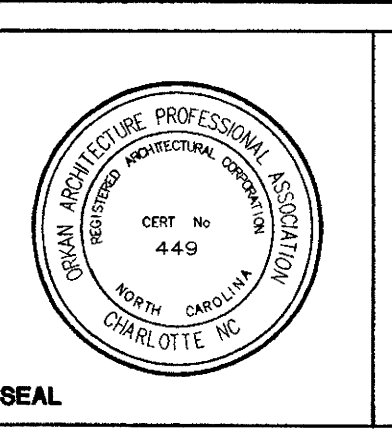
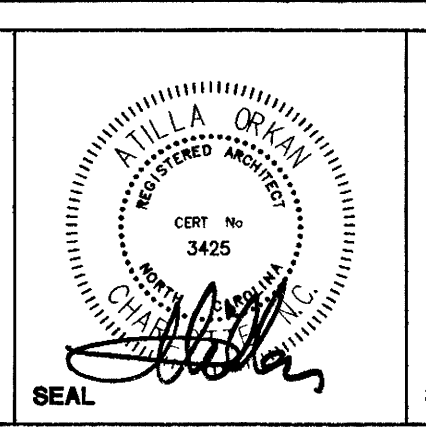

ARCHITECTURE PROFESSIONAL ASSOCIATION

4701 HEDGEMORE DRIVE
 CHARLOTTE NC 28209

TEL: 527-5545
 FAX: 527-5545